

POE-SP1224POE

Industrial Gigabit 30W PoE+ Splitter with Switchable DC 12V/24V Output and Passive PoE Output



Outstanding Features

DC 12V/24V Output Switchable

- Dual-Voltage Flexibility: 12V or 24V selectable via DIP switch for versatile power delivery.
- Broad Compatibility: Supports non-PoE devices (IP cameras, routers, IoT terminals).

Passive PoE or Gigabit Data Output

- Dual-Mode: Passive PoE power delivery or Gigabit data transmission selectable via DIP switch.
- Voltage Compatibility: 12V/24V Passive PoE (aligned with DC output to prevent device damage).
- Passive PoE Support: Powers non-standard PoE devices (wireless APs, bridges).

Gigabit Connectivity

- Gigabit Speed: All ports support 10/100/1000 Mbps auto-negotiation.

Industrial Design

- working temperature: -40°C~75°C (-40°F to 167°F).
- Electrical Protection: 6KV Surge protection and 8KV ESD protection.
- Compact Dimension: Full-metal design, dimensions 82.7 x 53 x 25.8 mm (3.26 x 2.09 x 1.02 in).
- Installation: DIN-Rail for industrial cabinets.

Interface

Front View

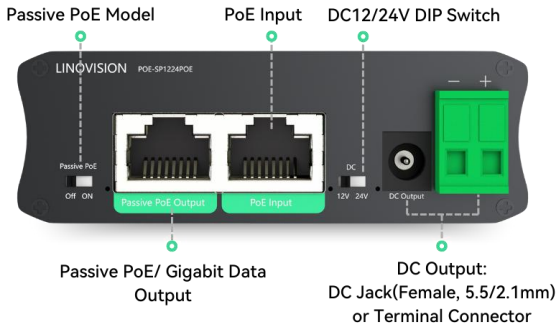

Rear View

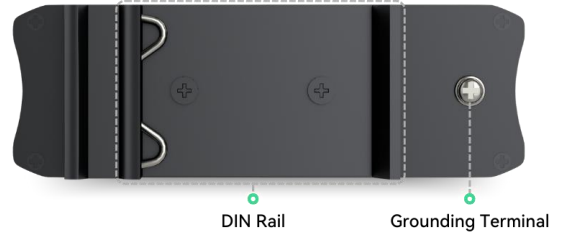

Connection Diagram

PoE Split to Gigabit Data + DC12V/24V

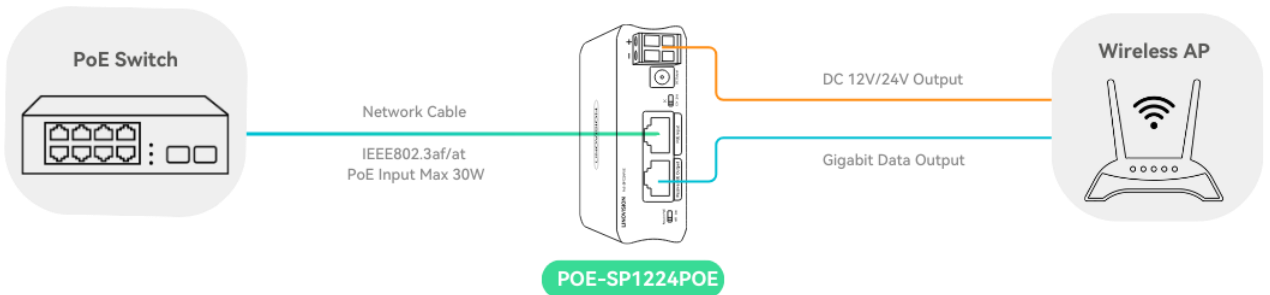

PoE Split to Passive PoE 12V/24V + DC12V/24V

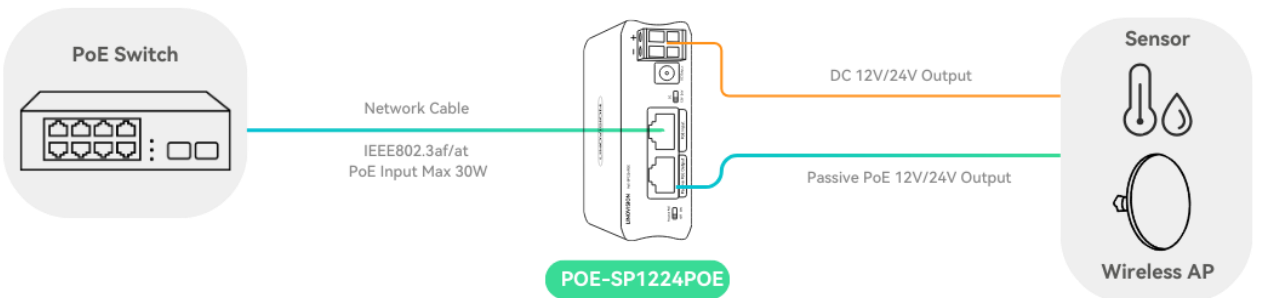

Noted: The Passive PoE and DC Output voltage must be the same and the total power is up to 25W

Specifications

Mechanical Specs	
Dimensions (W*H*D)	82.7 x 53 x 25.8 mm (3.26 x 2.09 x 1.02 in)
Weight	0.117 kg (0.258 lb)
Material	Aluminum
Installation	DIN-Rail
Interfaces	
PoE Input	1 * 10/100/1000Base-T RJ45 Port
Data Output	1 * 10/100/1000Base-T RJ45 Port
DC Output	DC Jack (5.5/2.1 mm Female) and Terminal Connector (Alternative)
Grounding	Grounding Terminal
PoE Input	
Standard	IEEE 803.2af/at
Power Supply	Mode A & Mode B
Power Requirements	PoE 36-60 V Max.30 W
Power Consumption	≤25.4 W
Output	
DC Output	12 V/24 V (DIP Switch control)
PoE & Data Output	Passive PoE 12 V/24 V or Gigabit Data (DIP Switch control)
Environment	
Operating Temperature	-40°C to 75°C (-40°F to 167°F)
Storage Temperature	-40°C to 85°C (-40°F to 158°F)
Humidity	0% to 95% non-condensing
Surge Protection	Differential mode ±3 KV, Common mode ±6 KV
Electrostatic Standard	Contact ±6 KV, Air ±8 KV

Dimension



Installation

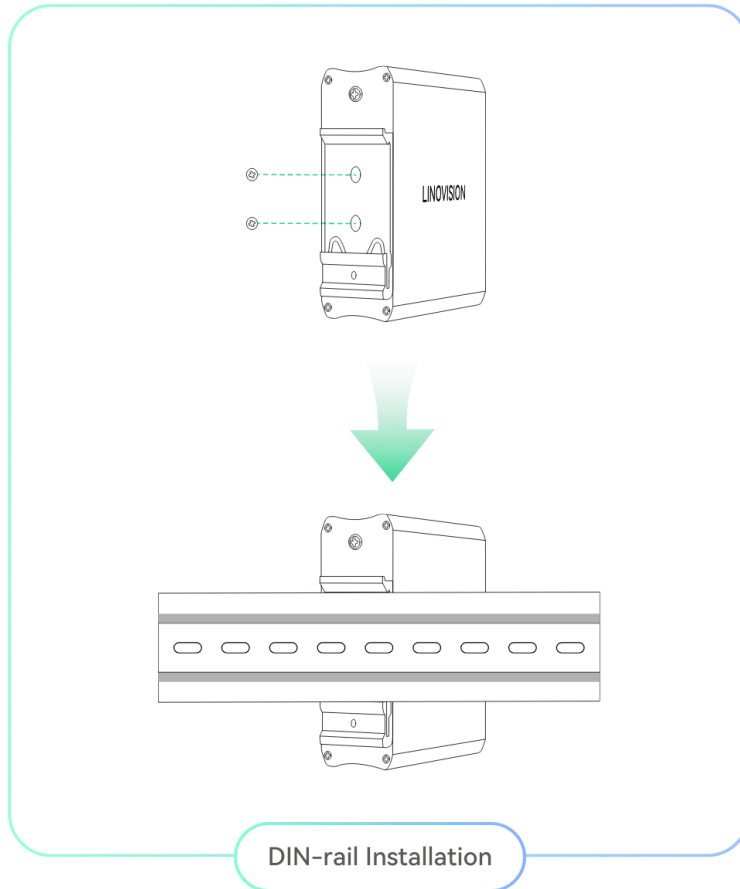

Package Contents



POE-SP1224POE



DIN-Rail Mounting Accessory



User Manual

**Disclaimer: Technical specifications may subject to change without prior notice*